

CONCORD



Luminaria bolardo clásica blindada. Líneas simples completamente blindadas, un giro moderno en la característica forma de bolardo de cañón.



Estructura luminaria

- Carcasa de aluminio fundido a presión
- Columna de aluminio extruido
- Pretratado antes del recubrimiento en polvo que garantiza una alta resistencia a la corrosión
- Entrada de un solo cable

- Un conector IP68 suministrado con 0,2 m de cable para exteriores de 3x1,0 mm²
- Sujetadores de acero inoxidable grado 304, Recubierto de escamas de zinc (ZFC)
- Junta de goma de silicona duradera
- Vidrio templado Opal

- Equipo de control integral

Característica



Símbolo de luz

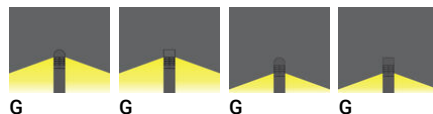

Colores del producto

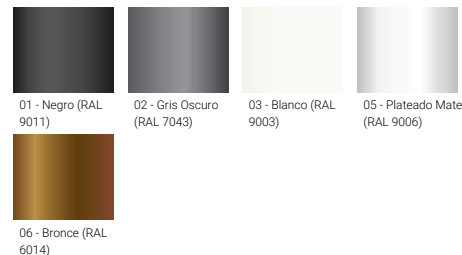

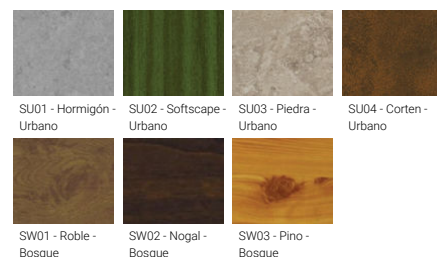

Acabados especiales bajo pedido





CONCORD

Información técnica

	Número de modelo	Fuente de luz	Poder	Lumen	Óptico	CCT / CRI	Tipo de atenuación	Peso	
Ø160 - 1024 mm - Flat top									
CONCORD 2	CN-10246-2	1 COB	41 W	922 - 927 lm	G [137°x 114°]	3000K CRI80, 4000K CRI80	DALI, 1-10V, On/Off	8.5 kg	
Ø160 - 1024 mm - Flat top - With integrated security core (Anti-traffic)									
CONCORD 2	CN-10246-2-SB	1 COB	41 W	922 - 927 lm	G [137°x 114°]	3000K CRI80, 4000K CRI80	DALI, 1-10V, On/Off	8.5 kg	
Ø160 - 1045 mm - Dome top									
CONCORD 2	CN-10246-1	1 COB	41 W	922 - 927 lm	G [137°x 114°]	3000K CRI80, 4000K CRI80	DALI, 1-10V, On/Off	8.5 kg	
Ø160 - 1045 mm - Dome top - With integrated security core (Anti-traffic)									
CONCORD 2	CN-10246-1-SB	1 COB	41 W	922 - 927 lm	G [137°x 114°]	3000K CRI80, 4000K CRI80	DALI, 1-10V, On/Off	8.5 kg	
Ø160 - 447 mm - Flat top									
CONCORD 3	CN-70156-2	1 COB	41 W	922 - 927 lm	G [137°x 114°]	3000K CRI80, 4000K CRI80	DALI, 1-10V, On/Off	5.9 kg	
Ø160 - 468 mm - Dome top									
CONCORD 3	CN-70156-1	1 COB	41 W	922 - 927 lm	G [137°x 114°]	3000K CRI80, 4000K CRI80	DALI, 1-10V, On/Off	5.9 kg	
Ø160 - 719 mm - Flat top									
CONCORD 1	CN-10236-2	1 COB	41 W	922 - 927 lm	G [137°x 114°]	3000K CRI80, 4000K CRI80	DALI, 1-10V, On/Off	7.1 kg	
Ø160 - 719 mm - Flat top - With integrated security core (Anti-traffic)									
CONCORD 1	CN-10236-2-SB	1 COB	41 W	922 - 927 lm	G [137°x 114°]	3000K CRI80, 4000K CRI80	DALI, 1-10V, On/Off	7.1 kg	
Ø160 - 740 mm - Dome top									
CONCORD 1	CN-10236-1	1 COB	41 W	922 - 927 lm	G [137°x 114°]	3000K CRI80, 4000K CRI80	DALI, 1-10V, On/Off	7.1 kg	
Ø160 - 740 mm - Dome top - With integrated security core (Anti-traffic)									
CONCORD 1	CN-10236-1-SB	1 COB	41 W	922 - 927 lm	G [137°x 114°]	3000K CRI80, 4000K CRI80	DALI, 1-10V, On/Off	7.1 kg	

Accesorios

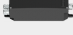
	 Anchor bolt A10291	 DALI Control System Control-DALI	 Power connection box (IP65) modification upon request POWER-BOX-IP65
CN-10236-1	•	•	
CN-10236-1-SB		•	
CN-10236-2	•	•	
CN-10236-2-SB		•	
CN-10246-1	•	•	•
CN-10246-1-SB		•	•
CN-10246-2	•	•	•
CN-10246-2-SB		•	•
CN-70156-1	•	•	

Nos reservamos el derecho a realizar cualquier cambio técnico o de diseño.

01:02, 21-04-2023

<https://www.ligman.com/es/concord-bolardos-con-bo3/>

THAILAND
LIGMAN Lighting Co.,Ltd.
17/2 Moo 4, Monthong, Bang Nam Priao,
24150 Chachoengsao - Thailand
info@ligman.com

CONCORD

CN-70156-2

CONCORD

CONCORD 1

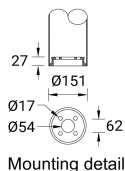
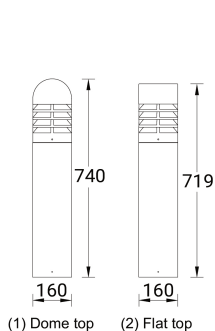

CONCORD 2

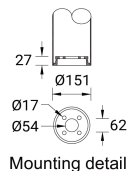
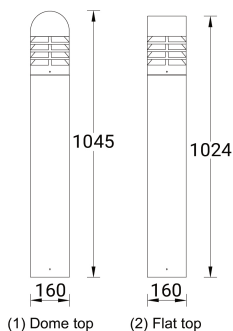

CONCORD 3

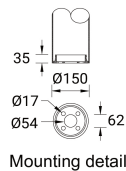
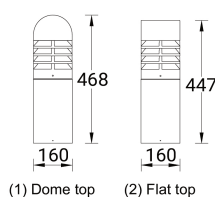

Top cover style

